

USER MANUAL

HDMI-EN-202505-V1.2

Elementz

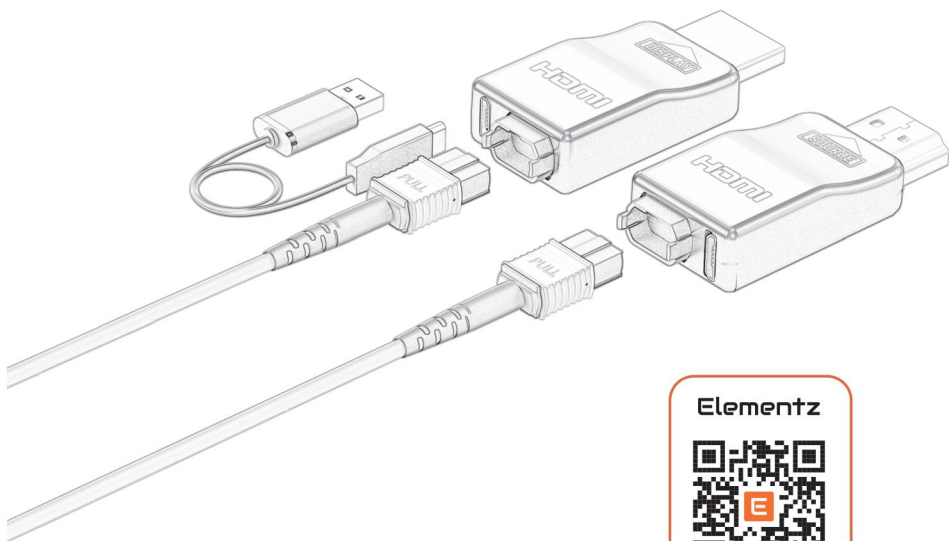

Elementz



Elementz.com.hk

Please read this user manual carefully before use.

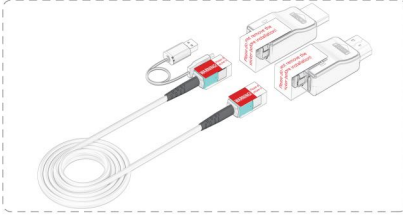

WITH STICKERS AND COVERS

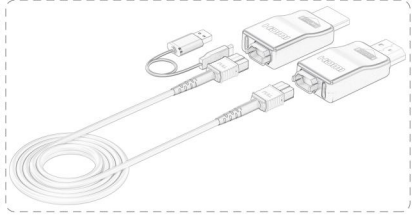

WITHOUT STICKERS AND COVERS

INSTRUCTIONS FOR USE

1. Pre-install the MPO Cable:

Pre-install the MPO cable or run it through a conduit carefully. The MPO cable is bi-directional.

Please don't remove the protective stickers and dust covers of the cable before the installation. Please don't bend the cable too sharply.

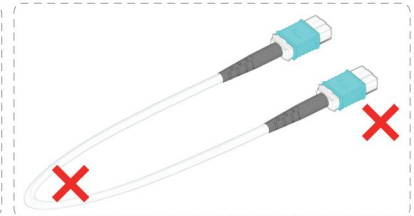
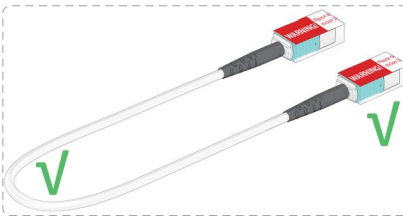

2. Remove the stickers:

After MPO cable installation, please remove the stickers and the covers of the MPO cable and the connector ends carefully.

Please don't touch the top surface of the MPO cable end.

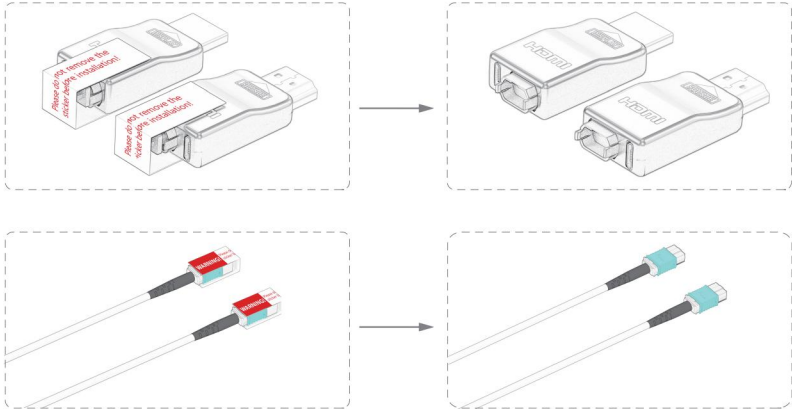

3. Assemble the MPO cable with the connector ends:

Plug the MPO cable to the "SOURCE" and "DISPLAY" connector ends. When plugging, hold the black part of the MPO cable and push it toward the connector end, making sure to align the cable with the direction of the connector end.

Please note that it must be aligned by the correct CONCAVE and CONVEX marks on both ends.

And make sure that you can hear a "click" when inserting the connector into the MPO for proper connection.

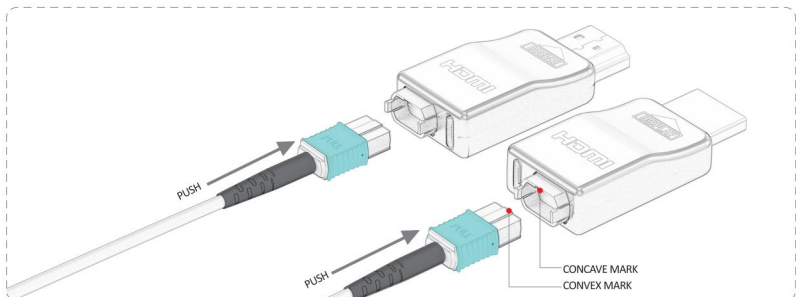

4. Connect the cable with your devices:

Please connect the "SOURCE" end to the SOURCE devices.
(Computer, TV player, HDMI input port of the AVR, etc.).

Please connect the "DISPLAY" end to the DISPLAY devices.
(TV, Projector, HDMI output port of AVR, etc.).



Plug the USB cable to the USB port of the display device to complete the final installation.

(The "SOURCE" end usually doesn't need this USB cable for power supply.)

To enable the CEC function, please connect a USB cable to both the "SOURCE" and "DISPLAY" ends. CEC only works when both source and display devices are powered on. Some devices do not supply power when turned off, please connect the USB cable to a USB-A port with continuous power output.



NOTES AFTER INSTALLATION

1. Please handle the cable gently, avoid sharp bends.

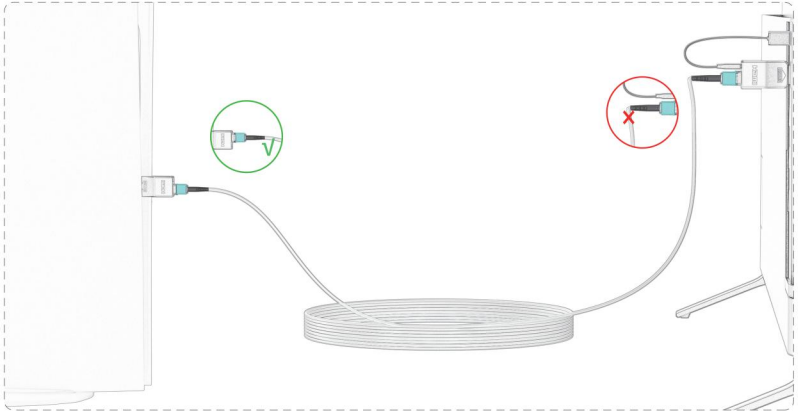

2. Keep the dust covers for future re-installation.

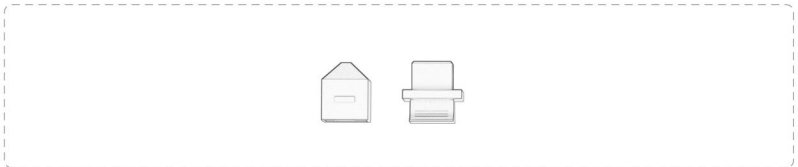

3. If you need to unplug the connector ends, please hold the BLUE AREA of the MPO cable and pull it out.

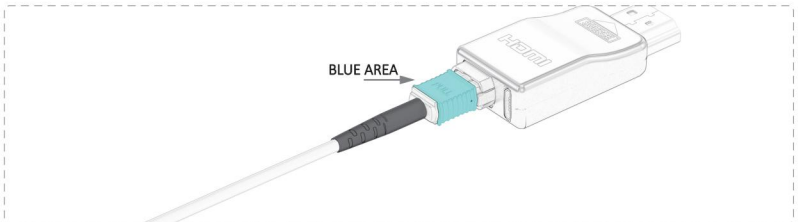

4. Please keep the MPO interface and connector clean, dust-free and free from damage. If needed, please gently wipe with the cleaning stick.

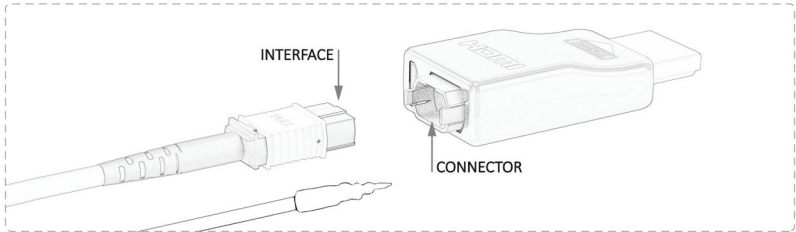

5 YEARS WARRANTY

This fiber optic HDMI cable is backed by 5 Years warranty, guaranteeing it against defects in materials and workmanship. If the cable fails due to manufacturing defects or normal use, we will repair or replace it at no cost to you.

The warranty does not cover damages caused by misuse, modifications, or external factors. Proof of purchase is required for warranty claims. Please contact the local seller to get customer service for assistance.

